

# Awards for Planning Excellence

*Western Australia*

---



20  
24 AWARDS FOR  
Planning  
Excellence

Western Australia

PLANNING INSTITUTE  
OF AUSTRALIA

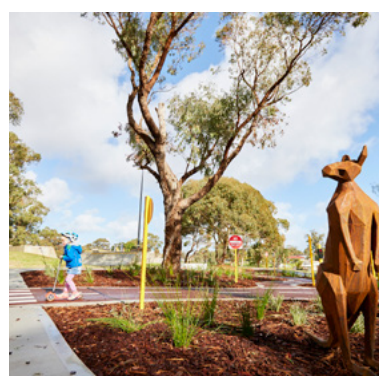
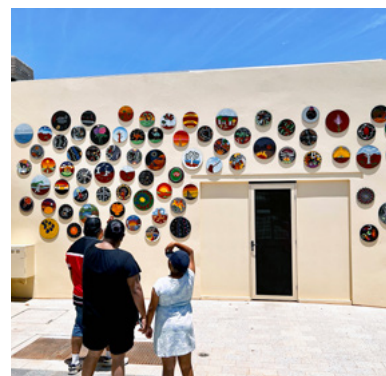
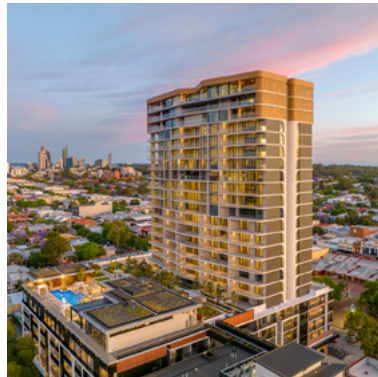

---

# Contents

Message from the Awards Convenor .....	04
Message from the President .....	05
2024 PIA WA Award Sponsors .....	06
2024 PIA WA Judging Panel .....	07
Award Winners & Commendations .....	09
Secondary Student Project .....	10
Tertiary Student Project .....	12
Eric Lumsden Award .....	14
Young Planner of the Year .....	16
Planning Champion .....	17
Great Place .....	18
Strategic Planning Project .....	19
Improving Planning Processes .....	21
Climate Change & Resilience .....	22
Stakeholder Engagement .....	25
Community Wellbeing & Diversity .....	27
Planning with Country .....	29
Planning Research .....	31
Performance and Innovation in Development .....	32
WA Regional Project .....	33
Small Consultancy of the Year .....	34
Large Consultancy of the Year .....	35
Local Government Team (Band 2-4) .....	36
Local Government Team (Band 1) .....	37
Leadership and Service Award .....	38
W E Bold Memorial Medal .....	39
President's Award .....	40
Minister's Award .....	41

# Convenor

## Message from the Awards Convenor

04

Message from the Awards Convenor

As the awards convenor, I am honoured to share this occasion with such a talented group who inspire us with their dedication, creativity, and commitment. The Awards for Planning Excellence recognises the outstanding achievements in urban and regional planning and allows us all to reflect on the significant role this profession plays in the very fabric of our cities and communities.

Urban planning is not just about designing spaces, it is about fostering connection, inclusivity, and sustainability. It is about envisioning spaces where families can thrive, where businesses can grow, and where nature can flourish alongside the hustle and bustle of urban life. So let this remind ourselves that our work transcends mere structures and roads; it is about improving the quality of life for all people.

I would like to take a moment to express my heartfelt gratitude to everyone who played a role in making this event possible—our sponsors, and all the judges. Your hard work and commitment behind the scenes are what allow us to come together in celebration of greatness.

To our nominees, I want to extend my sincerest congratulations. Your accomplishments showcase the very best in our field, each bringing a unique flavour and perspective to our collective work. Whether you have developed groundbreaking projects, provided exceptional service, or inspired others through your leadership, you are all deserving of recognition. You represent the drive for excellence that propels our community forward.

This year's awards are not only a celebration of past achievements but also an encouragement for the future. They remind us that every effort counts, and that your contributions—large or small—make a meaningful difference. I encourage each one of you to continue striving for excellence, to support one another, and to be the change-makers we need in our community.

As part of the awards, we honour individuals and teams who have challenged conventional thinking, innovated sustainable practices, and worked tirelessly to transform their visions into reality. From revitalising neglected neighbourhoods to developing green spaces that enhance urban biodiversity, your projects serve as beacons of hope and progress. You inspire not only your peers in the field but also future generations of planners, urban designers, and community leaders.

As we recognise the achievements of our esteemed award recipients, let us reflect on the importance of collaboration. Urban planning requires teamwork, involving multiple disciplines and perspectives, including community, Local Government, and a variety of diverse stakeholders. It is through collaboration that we can truly create resilient cities, enabling us to navigate the complexities of urbanization. This spirit of partnership is essential as we face the challenges ahead, from affordable housing to sustainable transportation solutions.

Let us also acknowledge the pressing issues we face today: climate change, housing shortages, and social inequality, to name a few. These challenges demand innovative solutions

and a bold reimagining of how our cities function. The work you have accomplished is not just a response to some of these challenges; it also represents a promise for a better future, so I encourage each of you to continue pushing the boundaries of what is possible. Let us build on the momentum we have created and advocate for urban planning that prioritises people and the planet.

To the award recipients, congratulations! Your hard work and dedication serve as an inspiration to all of us. May your success be a stepping stone toward even greater achievements in the world of planning and encourage those coming behind you.

It is encouraging to see so many people support the Awards for Planning Excellence. When I nominated for the role of awards convenor, it was my desire to grow awareness and support for their importance. Over the last three years, the number of nominations for awards have grown from 36 to this year's 62 nominations. To match this, the number of you coming along to support and recognise one another's achievements have grown every year, it is wonderful to see.

Thank you for being here, for your contributions, and for your commitment to excellence. This is my last year as convenor as I hand over the reins to Lisette Traves MPIA. I thank you for your support and - may the celebrations begin!

Megan Adair MPIA

Awards for Planning Excellence  
Convenor



Megan Adair MPIA

# President

## Message from the President

05

Message from the President

The WA Awards for Planning Excellence program recognises and celebrates individuals, teams, and community groups for their outstanding achievements, in, innovation, leadership, excellence, and dedication to sound planning practices. Over the years, we have expanded our award categories, and this year is no exception with the addition of the Performance and Innovation in Development Award.

I am delighted to announce that this year has been another successful one with 62 nominations, a host of new sponsors and a record number of tickets sold for our Gala Dinner, which promises to be another exceptional evening.

The success of the Awards program relies on the contributions of numerous stakeholders, including the substantial effort put forth by entrants in preparing their submissions, the dedication of our esteemed judges, the support of our sponsors, and the invaluable role played by our Awards Convenor, Megan Adair MPIA. This was Megan's final year as convenor, and before she hands over to Lisette Traves MPIA to take the reins, I would like to take this opportunity to thank her for the considerable amount of time and professionalism she has dedicated to the Awards program, resulting in three incredibly successful years.

I extend my heartfelt thanks to all of you for your time, enthusiasm, and commitment to this valuable program.

I would also like to extend my gratitude to the many individuals and organisations who dedicated their time to submit nominations for this year's awards.

Congratulations to all the Award for Excellence winners and Commendation recipients on your remarkable achievements. I wish you the best of luck for the 2025 National Awards for Planning Excellence.

Amanda Sheers MPIA



Amanda Sheers MPIA

PIA WA State President

A vertical promotional graphic for the WPN WA Awards 2025. It features a dark purple background with a circular logo at the top left that says 'WOMEN IN PLANNING NETWORK WA AWARDS'. The main text 'WPN WA Awards 2025' is in large, bold, white letters. Below this, it says 'Recognising the outstanding achievements of women in planning and allied fields'. Further down, it states 'Applications close 20 January (9AM WST)' and 'Find out more at [www.wpnwa.com/award](http://www.wpnwa.com/award)'.

Sponsored by:



Department of Planning,  
Lands and Heritage



Planning  
Institute  
Australia

# 2024 PIA Western Australia Award Sponsors

## PRINCIPAL SPONSOR



## GOLD SPONSOR



## GOLD SPONSOR



## BRONZE SPONSOR



## CATEGORY SPONSORS



# 2024 PIA Western Australia Judging Panel

## 07 JUDGING PANEL

2024 PIA Western Australia Judging Panel

Welcome to the 2024 PIA WA Awards for Planning Excellence. The Awards are an opportunity to share achievements and celebrate the value planning brings to our communities. They are a chance to showcase leading practice across a range of planning disciplines and sectors and to publicly recognise commitment to advancing the planning profession.



*Daniel Arndt MPIA (Fellow)*



*Megan Adair MPIA 2024 awards  
convenor*



*Sue Woolhouse MPIA (Fellow)*



*Andrew Dover MPIA*



*Clement Williams MPIA*



*Dr Shohreh Nematollahi MPIA*



*Shelley Shepherd MPIA (Fellow)*



*Dr Rebecca Scherini*



*Brett Wood-Gush RPIA (Fellow)*

# Judging

## 2024 PIA Western Australia Judging Panel



*Gareth Glanville*



*Anna Kelderman RPIA (Fellow)*



*Mathew Selby MPIA (Fellow)*

## Eric Lumsden Award Judges



*Kathy Bonus RPIA (Fellow)*



*Cameron Lecky MPIA*



*Peter Wittkuhn*



*Liam Herzfeld*

# Winners & Commendations

## Award Winners & Commendations

2024

# Secondary Student Project

## COMMENDATION

RUTH ANN -  
ROSSMOYNE SENIOR  
HIGH SCHOOL

## PROJECT

CECIL AVENUE, LOT 97

This urban design project for Lot 97 on Cecil Avenue demonstrates a sophisticated understanding of creating liveable higher-density environments. The proposal thoughtfully integrates community amenities, including the innovative 'Library of Things' concept, with sustainable design principles and cultural recognition. The project's consideration of practical community needs through research-based solutions, showcases a mature grasp of contemporary urban design. A commendable achievement in evidence-based urban planning.

10  
Secondary Student Project

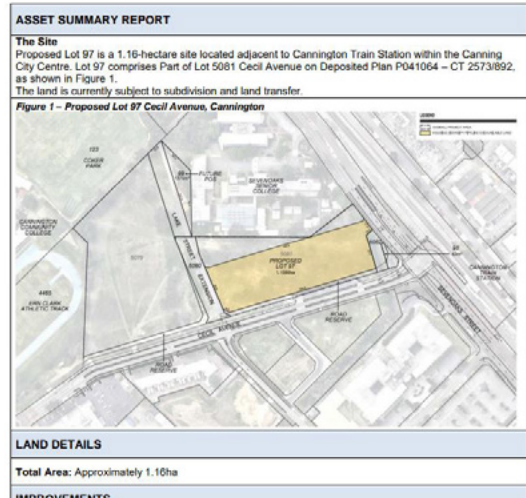

Category Sponsor





# Tertiary Student Project

**AWARD**  
LIAM PAGE

**PROJECT**  
BROOME NORTH  
CASE STUDY: HOW  
THE INTERESTS AND  
KNOWLEDGE OF FIRST  
NATIONS COMMUNITIES  
CAN BE IMPLEMENTED  
INTO URBAN PLANNING  
PROCESSES.

12

Tertiary Student Project

This research moves beyond simply asking how the knowledge and interests of First Nations communities can be incorporated into planning processes. It illustrates how Aboriginal knowledge has successfully influenced the design and added meaningful value to the outcomes of a master-planned development.

The conclusions and recommendations are grounded in a thorough research methodology, set within well-defined local contexts, allowing for comparison and adaptation to other regions. This well-documented case study sets a benchmark for the engagement and empowerment of First Nations communities in future strategic planning. It is hoped that the findings will significantly influence planning policy and practice across the State.

Category Sponsor

**urban design** | **plan development**  
planning and design for development



## 2.0 Literature Review

With the arrival of colonisation and the settlement of Australia, First Nations communities have been dispossessed of and displaced from the lands that they have had connections to for over 60,000 years (Flood 1996). Due to the fundamental role of planning in the management, administration and development of land, dispossession has been directly facilitated by western systems of planning in Australia (Jackson, Porter and Johnson 2017). Australia's colonial settlements utilised planning to create boundaries and borders that excluded First Nations population, often prohibiting First Nations people from areas (Wensing and Porter 2016). An example from Western Australia's capital city, Perth, shows a red line that determined the 'Native Prohibited Area' seen in Figure 1, which was enforced from 1927 until 1954 (Culture WA n.d.). In contemporary Australia, the majority of First Nations people live in urban areas, therefore challenging aspects of an First Nations peoples connection to Country (Frost, Williams and McLean 2022). Connection to Country is also highly nuanced and specific, requiring appropriately targeted consultation to understand the worldview of First Nations peoples (Russell and Ens 2020). First Nations people continue to have strong, continuing connections to Country, regardless of whether this connection is recognised through colonial systems of land rights, heritage and planning (Wensing 2019).

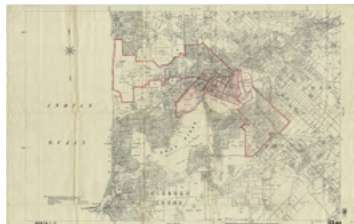

Figure 1: City of Perth - Prohibited Area Plan, initial exclusion zone outlined in red (Culture WA n.d.)

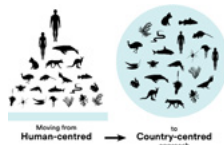

Figure 4: Human-centred or Country-centred Approach (GANSW 2023)

The Connecting with Country framework includes a section called 'Designing with Country' which sets out guidelines for how Country can be involved throughout a project lifecycle as well as giving the design considerations for buildings, small scale projects and precincts. Figure 5 is a simplified diagram of the place-based approach to project planning and delivery to design for Country by valuing health, wellbeing and being guided by First Nations Stakeholders (Webb et al. 2021).



Figure 5: Connecting with Country Place Based Approach (GANSW 2023)

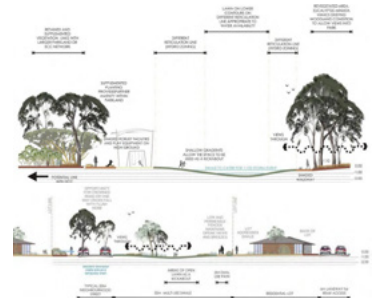

Figure 27 (top): Multi-use drainage corridor section diagram (UDLA 2009)  
Figure 28 (bottom): Multi-use swale drainage corridor section diagram (UDLA 2009)

The development manager and landscape architect both also mentioned how the lot drainage design differed from the usual approach of flattening lots. Instead creating drainage easements on lots to create a wholistic drainage solution seen below in Figure 29. The use of drainage swales running between lots connects each lots drainage to the larger system of multiuse corridor drainage as seen in figure 30. The resulting areas designated as multi-use corridors can be seen in figure 31.

# Tertiary Student Project

**COMMENDATION**  
WILSON HOLMES

**PROJECT**  
PERTH AUTONOMOUS  
RAPID TRANSIT (A.R.T)  
CORRIDOR

This research acknowledges the numerous challenges in implementing an Autonomous Rapid Transit (A.R.T) Corridor for Perth. Through a thorough research methodology, including a literature review and engagement with both the community and industry, the project successfully investigates these issues.

The project is commendable for its significant contribution to the ongoing discussion of barriers and solutions, particularly its focus on practical, implementable solutions that can be effectively integrated into the planning and transport systems.

Well done, Wilson!

Category Sponsor

**urban** | design  
**plan** | development  
planning and design for development

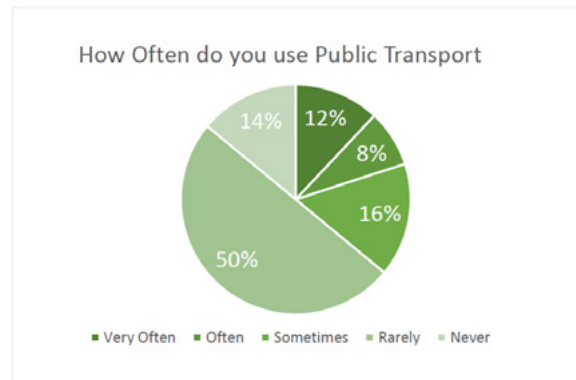

Figure 16 – Use of Public Transportation

Stakeholder	Involvement
Western Australian State Government	<ul style="list-style-type: none"> <li>Integration with the Mid-Tier Transport Strategy</li> <li>Provider of funding.</li> </ul>
Main Roads Western Australia (MRWA)	<ul style="list-style-type: none"> <li>Utilise existing roads</li> </ul>
Department of Planning, Lands and Heritage (DPLH)	<ul style="list-style-type: none"> <li>Connects to Primary and Other Regional roads</li> </ul>
Department of Transport (DoT)	<ul style="list-style-type: none"> <li>How the A.R.T Corridor will connect to the existing transport network.</li> </ul>
Public Transport Authority (PTA)	<ul style="list-style-type: none"> <li>Connection with the existing public transport network.</li> </ul>
Local Governments: <ul style="list-style-type: none"> <li>City of Fremantle</li> <li>Town of East Fremantle</li> <li>City of Melville</li> <li>City of South Perth</li> <li>Town of Victoria Park</li> <li>City of Perth</li> <li>City of Vincent</li> <li>City of Stirling</li> </ul>	<ul style="list-style-type: none"> <li>Falls within the listed LGA's requiring their involvement and consideration.</li> </ul>
Heritage Council	<ul style="list-style-type: none"> <li>Likely the proposed A.R.T Corridor will pass through heritage land.</li> </ul>
Residents and Tourists	<ul style="list-style-type: none"> <li>Impacted by changes to the transport network especially during the development of the project.</li> </ul>
Perth Metropolitan workers and road users	<ul style="list-style-type: none"> <li>Anyone who uses public transport or drives through The Perth Metropolitan Area.</li> </ul>
Local businesses	<ul style="list-style-type: none"> <li>Impacted during the development and works stage however will benefit post development.</li> </ul>
Media Outlets	<ul style="list-style-type: none"> <li>Play a role in informing the public of the project.</li> </ul>
Broader Public	<ul style="list-style-type: none"> <li>Anyone who uses public transport or drives through the Perth Metropolitan Area.</li> </ul>

**2.5 Relevant Documentation**

Based on the above mapping, table and through research of the planning framework the below table 3 outlines relevant documentation for consideration.

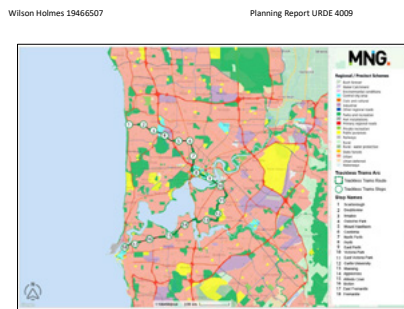

Figure 11 – Overview of Trackless Tram Arc over MRSI. Sourced: Edited MNG Access

**2.0 Project Background**

**2.1 Summary of Theories**

**2.1.1 Post-Modernism**

Prior to the rise of post-modernism, planning discourse and theory was dominated by Modernist theory, during the early 20<sup>th</sup> century where planning was conducted at a 'Masterplan' level typified by the likes of Le Corbusier and Frank Lloyd Wright (Filon, 2008). When it comes to the idealistic 'modernist city' it can be characterised through the vision of a 'functionalist city', that being a city that consists of 'high-rise buildings in its core, a 'field' of suburban housing and, an automobile focus to transportation' (Hajer and Wytske, 2019). The Stephenson Hepburn Plan, Perth's first major 'Masterplan' was inherently Modernist, through its high dependence on private vehicle ownership and 'intraurban' or more aptly Polycentric Urban Design (Irving, 1993). Post-modernism following this functionalist planning period rejects these notions, by fundamentally changing the approach to transportation methods. With Active transport and public transport modes dominating planning attitudes towards transportation, resulting in highly contrasting discussion and decision making in the planning of cities and how to move out of the modernist car dependent planning model many western

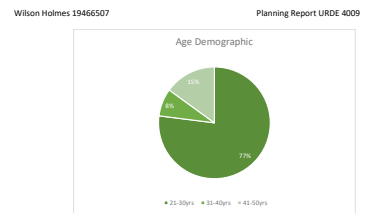

Figure 11 – Age Demographic

The below graph (Figure 12) highlights the gender demographic of the community survey respondents, which represents a reasonably balanced gender demographic with 53% of respondents reporting as male and 47% reporting as female. The survey provided sufficient options for respondents who may identify as 'other' however as evidenced below this was not selected by any respondents.

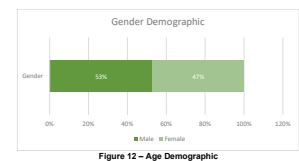

Figure 12 – Age Demographic

The below graph (figure 13) highlights the mode choice for respondent's daily commute. Respondents were provided with a multitude of options with the below being selected. As expected, and following the theme of this report the primary response was car at 60% with car as a passenger contributing another 10%, bus was selected by 20% of the respondents with active modes such as cycling and walking (5%) and bus and train (5%) rounding out the responses. As part of the questions bus and train was an option to allow for 'combined' trips which notably highlights that not one respondent selected train as their daily commute mode choice.

# Eric Lumsden Award

## Eric Lumsden Award

**AWARD TO**  
**STEPHANIE TAN**

Stephanie’s essay comparing planning governance in two Australian jurisdictions, showcased a sound conceptual framework, and the ability to engage in the discipline of systematic, comparative substantive presentation, which is so essential in planning practice. It comes on the back of solid and ascending academic performance, complemented by international exposure and commencement of work in the planning profession.



**COMMENDATION**  
**VIVIENNE ONG**

A commendation goes to Vivienne Ong for her essay in the Governance for Planning unit at Curtin University. Vivienne produced an insightful comparison of Governance under the WA and Queensland planning systems.

Financial Arrangements	Planning and Development Regulations Act 2009	Planning Regulations Act 2017
	establishes the right to charge fees for services.	establishes the right to charge fees for services.
	Developer contributions are part of infrastructure system in WA. State Planning Policy 3.6 – ‘Infrastructure Contributions’ is a guide for infrastructure contributions in WA.	PA Act 2016 establishes conditions and arrangements for infrastructure charges.

Sources: Data from ‘Western Australian Planning Commission (2022b); ‘Department of Housing, Local Government, Planning and Public Works (2024a); ‘Department of Housing, Local Government, Planning and Public Works (2022b); ‘Department of Housing, Local Government, Planning and Public Works (2023); ‘England (2019, 15)

As shown in Table 2 both states have similar provision for public participation and financial arrangements; and both state’s power is vested via enabling legislation. The two noteworthy differences between the states are their strategic policies and means regulation. Strategic policies are part both state’s planning systems however there are differences in their typology and preparation. In WA state-level strategic policies are prepared by the WA/PC (Western Australian Planning Commission 2024b). There are several tiers of policy as shown in Figure 2 below:



Figure 2. Western Australian Planning Framework  
Source: Figure reproduced from Western Australian Planning Commission (n.d)

# Young Planner of the Year

15 Young Planner of the Year

## AWARD

FARIDA FARRAG PIA (ASSOC.)

Just three years after completing her degree, Farida has become a quietly emerging leader in the industry. Since joining the PIA WA Young Planners Committee in 2021, she has significantly contributed to the position of young planners by mentoring recent graduates, speaking at state conferences, organising networking events, and serving on the UDIA WA Outlook committee, all while managing her daily commitments at Taylor Burrell Barnett Consultancy. The selection panel wishes her the best in her future endeavours in the planning industry.



Category Sponsor



Department of Planning,  
Lands and Heritage



# Planning Champion

## AWARD TO MARK IRWIN

Mayor Mark Irwin's leadership, advocacy, and innovative approach to supporting planning have been instrumental in the City of Stirling's success in delivering positive outcomes for its community. His commitment to encouraging innovative planning practices has resulted in improved planning outcomes across the city.

16

Planning Champion

His approach models how non-planners in leadership positions can effectively champion the planning profession and contribute to better outcomes for their communities. Notably, he has taken significant steps to promote the role of local government planners, including publicly advocating for their respectful treatment.

Mayor Irwin's ability to bridge the gap between planners and the public and his dedication to sustainable and efficient urban development makes him the 2024 PIA Planning Champion.



# Great Place

## Great Place

**AWARD TO**  
THE CITY OF  
KALGOORLIE-BOULDER,  
ELEMENT ADVISORY,  
ASPECT STUDIO,  
IREDALE PEDERSEN  
HOOK ARCHITECTS  
AND JOSH BYRNE AND  
ASSOCIATES

**PROJECT**  
ST. BARBARA'S SQUARE  
AND LANEWAY

The St. Barbara's Square and Laneway project revitalises the heart of Kalgoorlie, transforming it into a vibrant community hub deeply rooted in the area's distinctive historical, cultural, and environmental context.

This project is part of a broader revitalisation of Kalgoorlie's City Centre, guided by rigorous economic and place studies. These studies informed the driving vision for the development, encapsulated in the statement: "Shaped by Kalgoorlie's people and potential, our city centre pulses with the energy of a strong region; uniting community and commerce through new experiences, attractions, and special places for 'Kal life' to unfold."

Aspect played a key role in delivering the culturally informed 'Creative Template',

ensuring that the project was authentically shaped by local stories and heritage. The urban installations are bold and iconic, whimsical yet layered, reflecting the rich tapestry of Kalgoorlie's identity.

The design integrates innovative features and utilises endemic, climate-appropriate plant species. Additionally, an integrated Aboriginal public art programme has resulted in the creation of a captivating First Nations Public Art Gallery, adding another layer of cultural significance to the space. The space's colour, life and vitality highlight the potential of regional community revitalisation through a collaborative context-driven design approach.

St. Barbara's Square and Laneway, ability to foster social cohesion and contribute to a sustainable, culturally rich urban environment cements its status as a Great Place.

Category Sponsor



# Strategic Planning Project

**AWARD TO**  
ESTATES DEVELOPMENT  
COMPANY AND CITY OF  
WANNEROO

**PROJECT**  
JINDEE COASTAL VILLAGE  
STRUCTURE PLAN

Driven by a vision to create a unique housing estate responsive to its heritage and natural landscapes in the north west corridor of the Perth Metropolitan Region, the Estate Development Company (EDC) undertook a fourteen year journey to not only sell its vision of an integrated “coastal village” but more importantly, gaining the ‘buy-in’ of local and State authorities and builders to deliver a unique planning framework and build form outcomes together with its team of both local and international design consultants.

In this regard, the entrant created its own Form-Based Code based on an urban profile of the transect principles, the Jindee Code, endorsed through an extensive collaboration with authorities and community, including the City of Wanneroo, the Western Australian Planning commission, and Department of

Planning, Lands and Heritage. The result is the rezoning of the land to ‘Smart Growth Community’ under the City of Wanneroo District Planning Scheme and more significantly embedded in its structure plan, a Form-Based Code replacing the Residential Design Codes.

Its success is a testament on the ground with development commencing in 2016 and continues to be constructed today. Through its Jindee Architectural Standards which take the place of the Residential Design Codes, the importance of the project is its ability to demonstrate the implementation of the planning framework.

This achievement is well-deserved recognition for a project that has tirelessly pursued a vision that has been evaluated and successfully implemented.

*Category Sponsor*



# Strategic Planning Project

## COMMENDATION

DEPARTMENT OF BIODIVERSITY, CONSERVATION AND ATTRACTIONS (DBCA); URBAQUA; SHAPE URBAN; MP ROGERS & ASSOCIATES; PGV ENVIRONMENTAL; AND SOUTH WEST KINSHIPS

## PROJECT

ASHFIELD FLATS MASTER PLAN

Released in February 2024, the Ashfield Flats Master Plan receives a commendation from the Planning Institute of Australia (WA), recognizing its exceptional undertaking to develop a Master Plan in collaboration with an extensive stakeholder group, including engagement with traditional owners, authorities and community engagement.

The project demonstrates an extensive engagement programme to deal with an existing ecological system with its own constraints and challenges, the community, recreational and cultural uses

and infrastructure requirements under the control of three authorities both State and local government.

Although only in its early implementation stage, the foundation of a long-term management plan of some twenty years is set for the project area and should be commended for delivering a collaborative management plan.

Category Sponsor

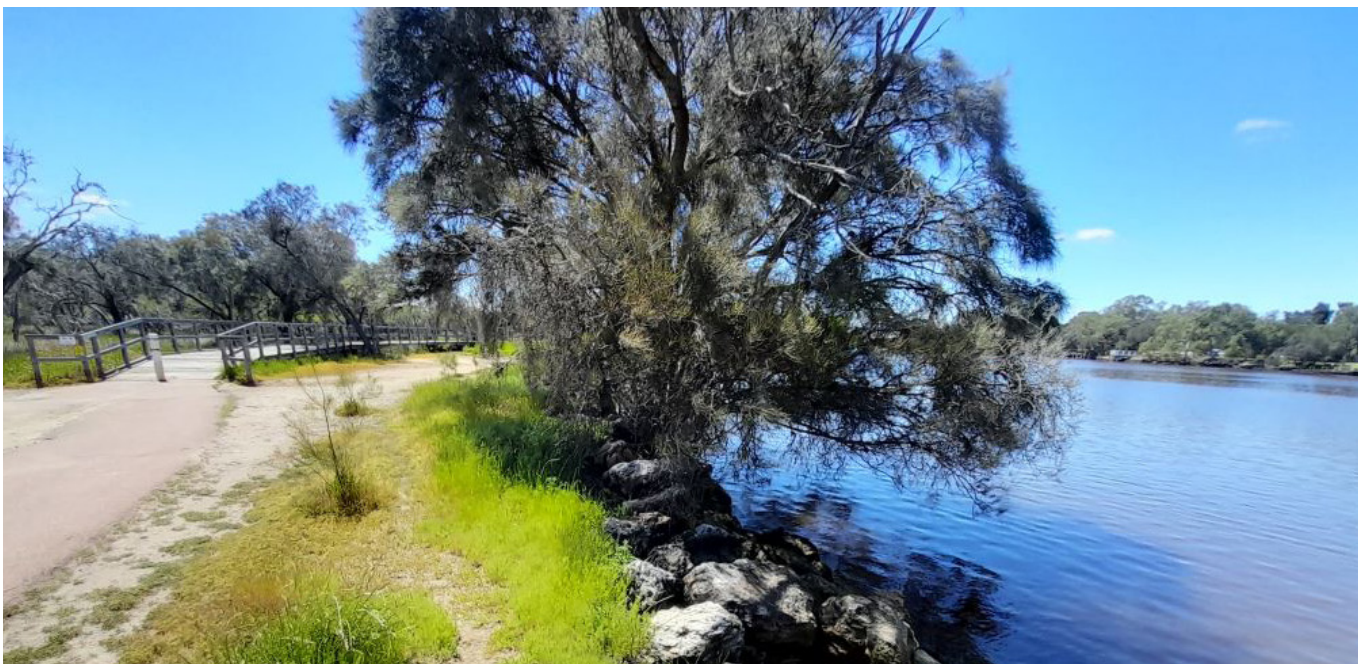

# Improving Planning Processes

## COMMENDATION DEPARTMENT OF PLANNING, LANDS AND HERITAGE, RISE URBAN AND KO&CO

## PROJECT DEVELOPMENT APPLICATION EXERCISE OF DISCRETION GUIDELINES

The Guidelines represent a positive step forward by establishing a clear and consistent set of principles for evaluating discretionary development applications. They assist local governments in enhancing transparency in the decision-making process and fostering greater community understanding and trust.

### Development Application Exercise of Discretion Guidelines February 2024

4

- the provision or standard no longer aligns with the strategic vision for the district as expressed in higher order planning documents,
  - the provision or standard is clearly not intended to be applied in this matter and the proposal is consistent with the overall objectives of the planning framework,
  - previous decisions on other properties in the same locality and planning context have been granted the same or similar discretion, and these decisions are orderly and proper,
  - there is a net greater good that can be achieved through this discretion. The greater good may apply to the development itself (e.g. where parking standards are waived to facilitate the installation of a significant tree), or to a broader level where an unanticipated local environmental or economic benefit will occur as a direct result of the discretion being exercised.
- Note: The greater good rationale is not to be confused with the principle of community benefit, which should only be used to justify a waiver where it is specifically contemplated and defined in the planning framework.
- Whatever the clear and logical reasons are, they must be communicated by the decision-maker so that the rationale for the discretionary decision is clear and logical to the casual observer.
- In performance based policies such as State Planning Policy 7.3 (Volume 1 and 8) B Codes and Apartment Codes the deemed to comply/acceptable outcome criteria are not to be considered a baseline standard. In these instances, the exercise of discretion must be guided by the corresponding development objectives, and the matters set out in clause 67(2) of the Deemed Provisions.
- 4.4 Public/community input has a legitimate role in the planning process**
- 4.4.1 In the level of consultation and engagement appropriate to the nature of the proposal?**
- Decision-makers should be informed of the way the public was consulted and ensure that the public was provided with their opportunity to provide input before a decision was made.
- 4.4.2 Are any public submissions duly considered and addressed?**
- The role of community consultation in the planning and decision-making process is vital. Often, community members are left feeling unheard and disatisfied by the planning decision-making process, particularly when the reasons behind a discretionary decision are not clear.
- Clause 67(2)(g) of the Deemed Provisions requires the decision-maker to have due regard to any submissions received on the application. This does not mean the court of public opinion should determine applications for development approval. Equally, it does not mean the decision-maker should dismiss, ignore or deny most any submissions received without first giving them due regard.
- Do public submissions raise planning considerations that would otherwise not be assessed?**
- Where public submissions raise substantive planning considerations, these matters should generally be given greater weight in the decision-making process than those that raise issues outside the realm of planning, such as impacts on property value.
- Substantive planning matters raised in submissions should be carefully considered in the assessment and any recommended decision for an application. Often, but not always, public submissions will raise planning matters such as traffic impacts, visual privacy, or height, bulk and scale, which need to be considered and given due regard in the decision-making process. In these responses, the input received from the community may add weight to a key planning consideration and provide specific acknowledgement to the decision-maker of matters of particular importance and relevance in the local context. Any input from the community, however, should be balanced against other competing factors in the planning framework.
- Public submissions may assist further in the determination process when the decision-maker is asked to form a view about the compatibility of development with its setting and the overall future character (Clause 67(2)(i)) (5) the due effect of height, bulk and scale, orientation and appearance (Clause 67(2)(m)(ii)), or the amenity of the locality (Clause 67(2)(n)).

### Development Application Exercise of Discretion Guidelines February 2024

7

#### APPENDIX 1 - CHECKLIST TO GUIDE DISCRETIONARY DECISION-MAKING

	Key considerations	Decision-maker's assessment
<b>Principle 1</b>	Has the planning framework been prepared and adopted in accordance with the relevant legislative requirements?	
<b>Principle 2</b>	<p><b>There should be a properly constituted planning framework</b></p> <p>Does the planning framework provide a clear standard/baseline and/or clear performance criteria?</p> <p>Does the planning framework provide criteria for when it may be appropriate to depart from the standard or baseline?</p> <p>Is the planning framework consistent with higher order planning instruments (e.g. State Planning Policy)?</p> <p>Are there any applicable state planning instruments that may be considered (Industry, Environmental/Planning)?</p> <p>Has there been a shift in the planning intent for the land or locality that is not captured in the framework?</p> <p>Does the development represent a form of development that is unique and/or is not anticipated by the relevant planning instrument?</p> <p>Is there an economic or community need for the development that is not adequately addressed by the current planning instrument?</p> <p>Are alternative uses in the planning framework that are outdated or have been superseded by subsequent research, data or adopted positions?</p> <p>Does the development represent a form of development that is unique and/or is not anticipated by the relevant planning instrument?</p> <p>Can the development be taken from other areas outside of the planning framework to reduce the future/overall impact on the baseline provision being sought?</p> <p>Can guidance be taken from other areas outside of the planning framework (e.g. previous planning decisions)?</p> <p>What is the baseline development control trying to achieve and are these clear and logical reasons to depart from that control?</p>	
<b>Principle 3</b>	<p><b>Look for guidance within the framework</b></p> <p>Is there guidance or established parameters within the planning framework to reduce the future/overall impact on the baseline provision being sought?</p> <p>Can guidance be taken from other areas outside of the planning framework (e.g. previous planning decisions)?</p> <p>What is the baseline development control trying to achieve and are these clear and logical reasons to depart from that control?</p>	
<b>Principle 4</b>	<p><b>There must be clear and logical reasons to depart from the standard</b></p> <p>Is there a cumulative impact of approving multiple 'minor' departures from a provision or standard?</p>	

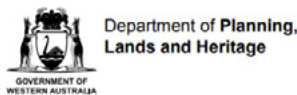

# Development Application Exercise of Discretion Guidelines

February 2024

# Climate Change & Resilience

**AWARD TO**  
CITY OF SUBIACO

**PROJECT**  
EMPOWERING  
SUSTAINABLE  
DEVELOPMENT: INSIGHTS  
FROM LOCAL PLANNING  
POLICY 1.3

Climate Change is affecting everyday life for residents and property owners. The City of Subiaco has tackled this head on and established a local planning policy framework that facilitates and enables its residents to adapt to climate change at a grass roots level. The framework uses an approach which is first in Australia, identifying 14 sustainability measures whilst allowing residents to nominate alternatives. The outcomes include community ownership of local sustainability, reducing greenhouse gas emissions, reduced utility costs, urban greening and increased community education on sustainable development.

21  
Climate Change & Resilience



Category Sponsor



# Climate Change & Resilience

## COMMENDATION CITY OF SWAN

### PROJECT TREE PROTECTION AND MANAGEMENT APPROACH

Development pressures at the edge of the urban area, needs to balance the growing demands of population growth, whilst ensuring that the natural environment is protected and enhanced. The City of Swan is drawing on cutting edge technology, early engagement with the development industry and the community to assist in retention and enhancement of the communities' natural future assets.



Category Sponsor



# Climate Change & Resilience

**COMMENDATION**  
HAMES SHARLEY IN ASSOCIATION WITH UDLA, ARUP, AND THE CITY OF VINCENT

**PROJECT**  
CITY OF VINCENT LINK AND PLACE GUIDELINES

The City of Vincent's Link and Place Guidelines reaffirm its leadership in people-focused, climate-responsive planning. Developed by Hames Sharley, UDLA, and ARUP with the City, the Guidelines challenge vehicle-dominated streetscapes, prioritising design, safety, and comfort for pedestrians, cyclists, and public transport users. Informed by extensive community consultation and collaboration with State agencies and other experts responsible for delivery, the Guidelines establish tailored responses by street type to increase tree coverage and promote traffic calming. By creating liveable streets, the Guidelines support infill development and foster vibrant, sustainable communities for the local area.

Category Sponsor



# Stakeholder Engagement

**AWARD TO**  
SHIRE OF BROOME

**PROJECT**  
WALMANYJUN CABLE  
BEACH FORESHORE  
REDEVELOPMENT

The judges were impressed by the targeted engagement sessions undertaken by the Shire of Broome with the Yawuru people and the youth-specific visioning exercises, including a focus on First Nations children.

Walmanyjun Cable Beach is one of the most iconic beaches in Western Australia, with a rich tapestry of interlinking cultural, environmental, coastal, community, tourism and economic factors.

Understanding all the challenges, opportunities, and non-negotiables in depth required the Shire of Broome to implement an original and innovative multilayered engagement process. The judges felt that the Shire's approach to balancing these competing interests for the optimal outcome was an outstanding achievement.

The innovative steps of including traditional owner representatives, the Nyama Buru Yawuru, on the Steering Committee overseeing the project created a high level of transparency. They also ensured First Nations input into determining a balanced, holistic outcome.

The Shire of Broome is congratulated on this innovative exemplar in community engagement and planning.

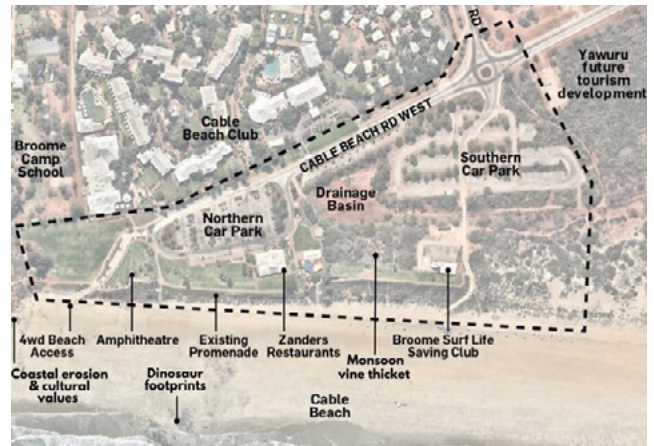

Category Sponsor



# Stakeholder Engagement

**COMMENDATION**  
DEPARTMENT OF BIODIVERSITY, CONSERVATION AND ATTRACTIONS, URBANA, SHAPE URBAN, MP ROGERS & ASSOCIATES, PGV ENVIRONMENTAL AND SOUTHWEST KINSHIPS

**PROJECT**  
ASHFIELD FLATS MASTER PLAN

The judges applauded the project team headed by the Department of Biodiversity, Conservation and Attractions for creating a shared vision and coordinated management approach through a highly collaborative and consultative process.

How this cross-governmental project navigated differing agendas to achieve a shared goal is highly commendable. The ability to establish shared community and stakeholder visions and principles for the site, with Whadjuk and Nyungah representatives and passionate community groups, through a variety of channels provides a blueprint for how multiple agencies responsible for the

management of a single area can collaborate to develop a coordinated plan for that area.

The project teams' approach to using an interactive online engagement platform allowed for a highly visual broad reach and the provision of accessible space for the community and stakeholders to share feedback, complete consultation surveys, and promote consultation events. Overall, their methodology for engaging with all community segments enabled the project to be successful and should be recognised.

Category Sponsor



# Community Wellbeing & Diversity

**AWARD TO**  
CITY OF KWINANA

**PROJECT**  
CALISTA BIKE SKILLS  
TRACK

This project inspires young community members to experience active travel, such as cycling and scootering. The facility enhances kids' bike riding skills in a safe and fun place. It serves as an educational platform for them to learn basic road rules, empowering them to explore their neighbourhood in later years by cycling.

26

Community Wellbeing & Diversity



# Community Wellbeing & Diversity

**COMMENDATION**  
 HAMES SHARLEY IN  
 ASSOCIATION WITH  
 UDLA, ARUP, AND THE  
 CITY OF VINCENT

**PROJECT**  
 CITY OF VINCENT LINK AND  
 PLACE GUIDELINES

The guideline highlights adapting an international framework to the local context. It emphasises that streets should not only facilitate movement but also serve as destinations for residents, employees, and visitors. It proposes a hierarchy of streets that prioritises active travel users while paying particular attention to specific user groups, including women, children, older people, and individuals with disabilities.

27  
 Community Wellbeing & Diversity



# Planning with Country

## AWARD TO

CAUSEWAY LINK ALLIANCE COMPRISING MAIN ROADS WA, CIVMEC CONSTRUCTION AND ENGINEERING, WSP AUSTRALIA, SEYMOUR WHYTE AND PARTNER ORGANISATIONS, DEPARTMENT OF TRANSPORT, 361 DEGREES STRATEGIC ENGAGEMENT AND COMMUNICATIONS, HASSELL, ELEMENT ADVISORY, INDIGENOUS ECONOMIC SOLUTIONS, ABORIGINAL LAND SERVICES

## PROJECT

CAUSEWAY PEDESTRIAN AND CYCLIST BRIDGES PROJECT

This exemplary co-designed project which from the outset is based on engagement with the Traditional Owners of the land and waters. From pre-feasibility through site selection to final design and construction, the cultural significance and interpretation of the place has been paramount. The is, demonstrated through every aspect of design. The inclusion boomerang and digging stick pylons and limiting the bridge to only three piers to minimise spiritual disturbance of this important site demonstrates

the remarkable scale Causeway Link Alliance's commitment to interpreting the Noongar culture and history, reversing the usual subservience of culture to budget.

The innovative procurement methodology which permitted stakeholder engagement during the tender phase, enabling proponents to better understand the cultural significance of the project and the site, further demonstrates lengths to which the Alliance has gone to ensure that the local Noongar culture and the significance of the place is integral to the completed project. The completed project includes co-designed public art by leading and emerging Noongar artists, a corroboree space and interpretive signage explaining the significance of the site and sharing site-specific stories, passed from generation to generation. This project is a guiding light for others, demonstrating excellence in Planning with Country for all others to emulate.

Category Sponsor



# Planning with Country

29

Planning with Country

**HIGH COMMENDATION DEVELOPMENTWA IN PARTNERSHIP WITH APPARATUS AND KARRDA ON BEHALF OF THE NOONGAR PEOPLE THROUGH THE SUBI EAST WHADJUK ELDERS GROUP**

**PROJECT**

SUBI EAST: HOW A NEW APPROACH TO "PLANNING WITH COUNTRY" IS EMPOWERING CAREERS

This project exemplifies engagement with and empowerment of Traditional Owners to co-design an indigenous self-learning cultural trail, ensuring Subi East's progressive redevelopment is grounded in country. This trail continues the historic connection of people to country and culture.

The collective trail as well as each individual artwork is the result of active inclusion, collaboration partnerships and open communication with the traditional landowners, the Noongar artists and Development WA. This inclusion extended to entry level public artists, facilitated by experienced mentors, removed significant barriers and creating art, opportunities and active and connected places. This project has allowed the traditional owners of the land to tell their own story in their own way, without filtration through an interpreter. This project is highly commended.

*Category Sponsor*



# Planning Research

**AWARD TO**  
 DR FRANCESCA  
 PERUGIA, PROFESSOR  
 STEVEN ROWLEY,  
 ASSOCIATE PROFESSOR  
 MOHAMMAD SWAPAN

**PROJECT**  
 IMPROVING  
 AUSTRALIAN CLIMATE  
 CHANGE ADAPTION  
 STRATEGIES: LEARNING  
 FROM INTERNATIONAL  
 EXPERIENCE

30

Planning Research

This AHURI research report is a deserving winner of the Planning Research Award. It addresses a critical aspect of planning essential to the health and safety of our future communities and landscapes. The report presents a pathway for improving the resilience of urban and regional settlements to natural disasters, identifying three key strategic approaches and a framework for adoption across Australia.

By drawing from international case studies and supported by interviews with local stakeholders, this research illustrates how both immediate and long-term planning interventions can greatly enhance the resilience of Australian communities and infrastructure. Congratulations to the AHURI team, Dr Perugia, Professor Rowley, Associate Professor Swapan!

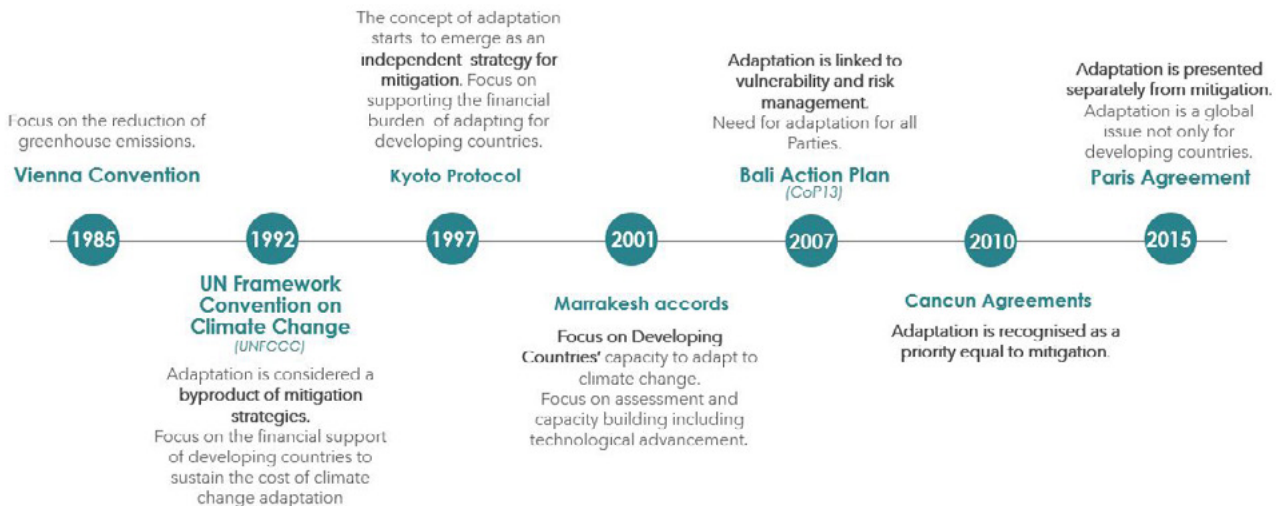

# Performance and Innovation in Development

**AWARD TO**  
CITY OF SUBIACO,  
BLACKBURNE GROUP,  
HAMES SHARLEY &  
PLANNING SOLUTIONS

**PROJECT**  
ONE SUBIACO

Delivering much needed inner-city density, the Nominees' collaboration with the City of Subiaco on community benefits and design outcomes have resulted in both a significant high-quality example of density done well, and an outstanding result for the community of Subiaco and West Australians more broadly.

This application demonstrates a vision to bring the Subi Markets back in a modern interpretation, setting the stage for many events for the benefit of the community at large.

Supporting infrastructure delivered in the pavilion and adjoining public realm will make event planning easier, concessions for public and adjoining property accessibility will pave the way for others to also contribute to the space, and other public amenity delivered will provide the community with more options to stay and enjoy one of our longest standing growth centres.

The Judges recognise the nomination for its commitment to collaboration, good design and the design review process, and the delivery of some excellent community-oriented spaces and amenity.



# WA Regional Project

# Project

**AWARD TO**  
THE CITY OF  
KALGOORLIE-BOULDER,  
ELEMENT ADVISORY,  
ASPECT STUDIO,  
IREDALE PEDERSEN  
HOOK ARCHITECTS  
AND JOSH BYRNE AND  
ASSOCIATES

**PROJECT**  
ST. BARBARA'S SQUARE  
AND LANEWAY

Regional communities, and particularly inland communities, face the constant challenge of high community turnover and the specific loss of young people and families that often create the energy and vibrancy of centres.

In this project the project team have worked over nearly a decade to methodically deliver a community led vision. The vision was carefully developed, with a notable mention to this nomination for its extensive First Nations collaboration.

The outcome, now on the ground and creating a vibrant local space, will ensure children and young people, First Nations people, and broader community have a space to come, enjoy, sit and play, building social cohesion and contributing to community well-being.

In recognising this nomination, the judges want to recognise the hard work that many regional communities face with ever increasing centralisation of services, and the resulting departure of supporting services and industry. The nominees have delivered an impressive revitalisation that will encourage new development and business growth; and a place for the community to call their own.

*Category Sponsor*



# Small Consultancy of the Year

## AWARD TO RISE URBAN

Rise Urban has consistently proven its ability to manage and deliver multi-disciplinary projects, achieving high-quality planning outcomes rarely associated with small consultancies in Western Australia. The company's strong focus on relationships, integrity, service, and excellence forms a solid foundation, empowering them to make a positive impact.

Their leadership's unwavering support for both the planning profession and their staff is truly commendable. Rise Urban is not only an exceptional consultancy but also a fantastic place to work. We wish them continued success in the future!

Small Consultancy of the Year 33



# Large Consultancy of the Year

## AWARD TO TAYLOR BURRELL BARNETT

Taylor Burrell Barnett pioneered advancements in planning in Western Australia during the 1960s and 70s, and it is evident that while their methods have evolved, their commitment to curiosity, deep thinking, and problem-solving remains steadfast. Their creative and knowledgeable team is empowered to explore every opportunity, ensuring their work makes a meaningful impact today and supports a sustainable, thriving future.

Team members are encouraged to pursue continuous learning and growth in a culture where curiosity is encouraged. Collaboration keeps the team dynamic, while ongoing professional development, mentoring, and feedback create a supportive environment where talent can flourish.

Taylor Burrell Barnett's professionalism is outstanding, and the breadth and depth of their corporate citizenship are exemplary.

They are worthy winners of the 2024 PIA Large Consultancy of the Year



Category Sponsor

**MCLEOD  
FISHER &  
HAMDORF**



# Local Government Team (Band 2-4)

## AWARD TO CITY OF VINCENT STRATEGY & DEVELOPMENT TEAM

This nomination exemplifies an innovative and collaborative approach to progressive urban development projects that contribute towards sustainable outcomes and vibrant urban paces, as well as a demonstrated commitment to improving statutory planning processes and staff training and development.

Furthering sustainable urban design outcomes, the future redevelopment of Leederville's carparks will inject \$300million of investment into the town centre. In addition to this investment in the private realm, the city also supported economic growth and improved our public spaces by contributing over \$114,000 in funding for business enhancement projects.

The nomination demonstrates improvements to the administrative processes achieving a 25% reduction in development application processing timeframes over the past 12 months, while ensuring high quality design outcomes are achieved. The implementation of a Green Track priority assessment service has acted to incentivise and improve the sustainable design of homes.

A commitment to staff development is demonstrated through leadership and training programs, mentorship, and growth opportunities within the City.

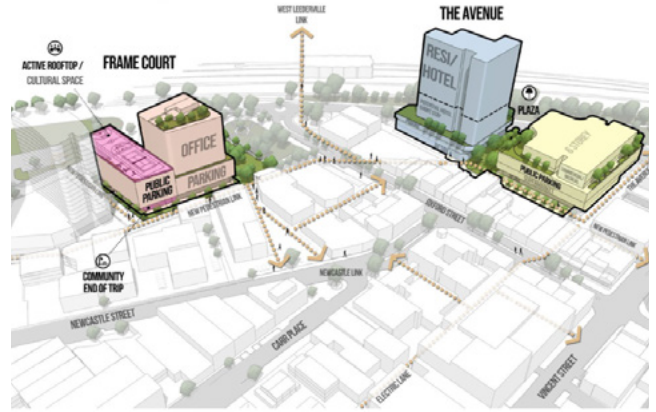

Category Sponsor



# Local Government Team (Band 1)

## AWARD TO TOWN OF PORT HEDLAND PLANNING AND ECONOMIC DEVELOPMENT TEAM

The Town of Port Hedland's planning team exemplifies outstanding achievement in local government through exceptional innovation and leadership in regional planning. Their pioneering approaches to workforce accommodation and community engagement are models for local government practice. This is particularly evident in their successful negotiation of Community Contribution Agreements to secure vital infrastructure investment. The team's establishment of a regional Design Review Panel and their role in transformative projects like the Hedland Hotel redevelopment demonstrate exemplary professional standards. Their commitment to multidisciplinary collaboration, combined with a strong focus on staff development and workplace culture, has created

a highly effective and respected planning service. Through transformational leadership and community-focused solutions, they have significantly elevated the standard of regional planning practice, making them worthy recipients of this award for excellence.



36

Local Government Team (Band 1)

Category Sponsor



# Leadership and Service Award

## AWARD TO KATHY BONUS RPIA (FELLOW)

Kathy's exhibited exceptional leadership in delivering the State Government's significant planning reform agenda.

Kathy's ability to lead her team to exceptional results is evident in the outcomes she achieves with and through others. Throughout this reform process, Kathy has enhanced relations and support for planning across all levels of government, industry, and professional organisations by effectively informing and listening to all parties involved.

Kathy's approach to stakeholder engagement has been exemplary, significantly enhancing the credibility and reputation of the Department of Planning Lands and Heritage and the Western Australia Planning Commission. Her ability to build and maintain positive relationships with stakeholders is a clear indicator of her leadership qualities and commitment to service. Kathy is also dedicated to good governance and integrity in the practice of public administration.

In recognition of her outstanding achievements and unwavering commitment to service excellence, Kathy deserves to be honoured with this award.



# W E Bold Memorial Medal

## DAVID CADDY RPIA (LIFE FELLOW)

David has made a significant contribution to the WA planning system over the last 40+ years.

David has been a passionate, confident and highly effective leader and role model to many in the profession. He has been instrumental in the evolution of the State's planning system and processes to facilitate better outcomes which benefit both the community and industry.

David's leadership, quiet determination and motivation for improving outcomes seeing him well-respected by professionals in both the private and public sector and establishing him as an excellent role model and educator to all professionals in the industry.

David has always been absolutely committed to the profession and elevating the role of planning in the State and supported the growth of many planners within Western Australia.

He has dedicated his career to the pursuit of planning excellence and the growth of the profession, going about his work with a quiet modesty but innate leadership and determination to achieve results. David's contributions have been recognised when he was made a Life Fellow of PIA and awarded the Outstanding Leadership and Service Award for Planning Excellence in 2022.

David embodies the vision of the planners everywhere to create better places to live and work for all Western Australians and is a very worthy recipient of the W E Bold Memorial Medal.



# President's Award

## AWARD TO LIAM PAGE

### PROJECT JAMES STREET PRECINCT-

Broome North Case Study: How the interests and knowledge of First Nations communities can be implemented into urban planning processes.

This exemplary project embodies the essence of what we cherish in planning, creating better outcomes for all. It goes beyond merely exploring how to incorporate the knowledge and interests of First Nations communities into planning processes. Instead, it demonstrates tangibly how Aboriginal knowledge has successfully influenced design and added meaningful value to the outcomes of a structure planning process.

The strength of this research lies in its comprehensive methodology and well-defined local contexts, which allow for comparison and adaptation to other regions. By providing a well-documented case study, it establishes a benchmark for the engagement and empowerment of First Nations communities in future strategic planning projects.

This Project sets a new standard for inclusive and culturally sensitive planning, showcasing the immense value that can be derived from meaningful collaboration with First Nations communities. It represents a significant step forward in creating more equitable, sustainable, and culturally rich environments.



President's Award 39



Figure 3: Indigenous Landscape values – Shaping South East Queensland Regional Plan (Queensland Government 2017)

The place-based approach steps can be further explained with Figure 6 expanding on the full range of suggestions for project implementation at all stages; Sensing: Starting with Country (project formation), Imagining: Listening to Country (project design and conceptualisation), Shaping: Design with Country (project delivery) and Caring for Country: Maintaining Country (project maintenance) (Webb et al. p 2021; White and Hespagnol 2022).



Figure 6: The proposed framework: 5 core stages for the design process, 15 design principles and 29 methods mapped to the timeline (White and Hespagnol 2022)

In a pilot example of the framework being used in a major project, the planning of Sydney Metro – Western Sydney Airport included a document called 'Connecting with Ngura [Country]' (Webb et al. 2021). Connecting with Ngura was created by a group of industry First Nations consultants (planners, engagement facilitators) and a working group of Dhanag and Dharawal Traditional Owners to work with Sydney Metro team. The purpose of the document is to provide guidance for delivery partners on the Western Sydney Airport



Figure 35: Amendments to respond to ECC (TBB 2022)

These changes can be seen above in figure 35, which shows the positioning 'bush living lots' to the ECC, as well as the closing of Fairway Drive to extend the A class reserve. Figure 36 below gives further detail showing use of further setbacks on R2-R10 'bush living' lots called 'bush retention zones' which are 18m-20m setback that improve interface with ECC. The setback solution better responds to Yawuru's requests around sightlines into the A-class reserve and ECC, rather than permitting development directly overlooking ECC. The extension of the A-class reserve happened over the two lots owned by Yawuru Native Title Holders a decision that also involved input from the Planner to understand the development potential of these lots (TBB 2022). Paired with the extension of the A-class reserve, this gives two benefits to Yawuru use of ECC and A-class reserve; improved protection of culturally important sites at the Cable Beach dunes as well better interface with housing and reserves.

# Minister's Award

**AWARD TO**  
THE CITY OF  
KALGOORLIE-BOULDER,  
ELEMENT ADVISORY,  
ASPECT STUDIO,  
IREDALE PEDERSEN  
HOOK ARCHITECTS  
AND JOSH BYRNE AND  
ASSOCIATES

**PROJECT**  
ST. BARBARA'S SQUARE  
AND LANEWAY

The St. Barbara's Square and Laneway project exemplifies exceptional vision, innovation, and collaboration in the revitalisation of one of Western Australia's most iconic regional centres.

Vibrant precincts that attract people to live, work and play are critical to the ongoing success of both urban and regional town centres and I congratulate everyone involved in this project.

This transformative redevelopment has breathed new life into the city centre, creating a new opportunity for local business growth and community pride.



# Minister's Award

## Minister's Award

**COMMENDATION**  
CITY OF SUBIACO,  
BLACKBURNE GROUP,  
HAMES SHARLEY &  
PLANNING SOLUTIONS

**PROJECT**  
ONE SUBIACO

This commendation acknowledges the One Subiaco development as a leading example of high-density infill development in Perth, providing more housing choice and vibrancy to the Subiaco town centre and station precinct.

Through the renewal of a prominent site in Subiaco, the project has made an exceptional contribution to Perth's urban landscape and has positively shifted common misconceptions of higher-density infill development.





# Western Australia's Leaders in Planning & Environment Law

42

Minister's Award



**Craig Wallace**  
Lead Partner  
Planning & Environment



**Paul McQueen**  
Partner and General Counsel  
Planning & Environment



**Alex McGlue**  
Special Counsel  
Planning & Environment



**Isabella Mosole**  
Senior Associate  
Planning & Environment



**Jessica Pollock**  
Lead Practitioner  
Native Title & First Nations



**Isabel Bartel**  
Solicitor  
Planning & Environment

Lavan is a respected leader in planning and environment law in Western Australia, offering a comprehensive range of services that cover all aspects of land development and property transactions.

Lavan represents prominent Western Australian landowners and property developers in relation to some of the most significant developments and projects across the state.





SHAPING THE FUTURE OF WESTERN AUSTRALIA

## The Western Australian Planning Commission is pleased to be **Gold sponsor** of the WA Awards for Planning Excellence 2024.

As the State continues to consolidate important planning reforms, this awards program is a valuable way to inspire new benchmarks that align with the Commission's mission to create better places for all Western Australians to live, work and recreate.

The Commission congratulates all this year's finalists and wishes everyone an enjoyable evening.

Commissioners would also like to take this opportunity to thank all of Western Australia's planners for their hard work and dedication to building better communities over the past year.



[planning.wa.gov.au/wapc](https://planning.wa.gov.au/wapc)



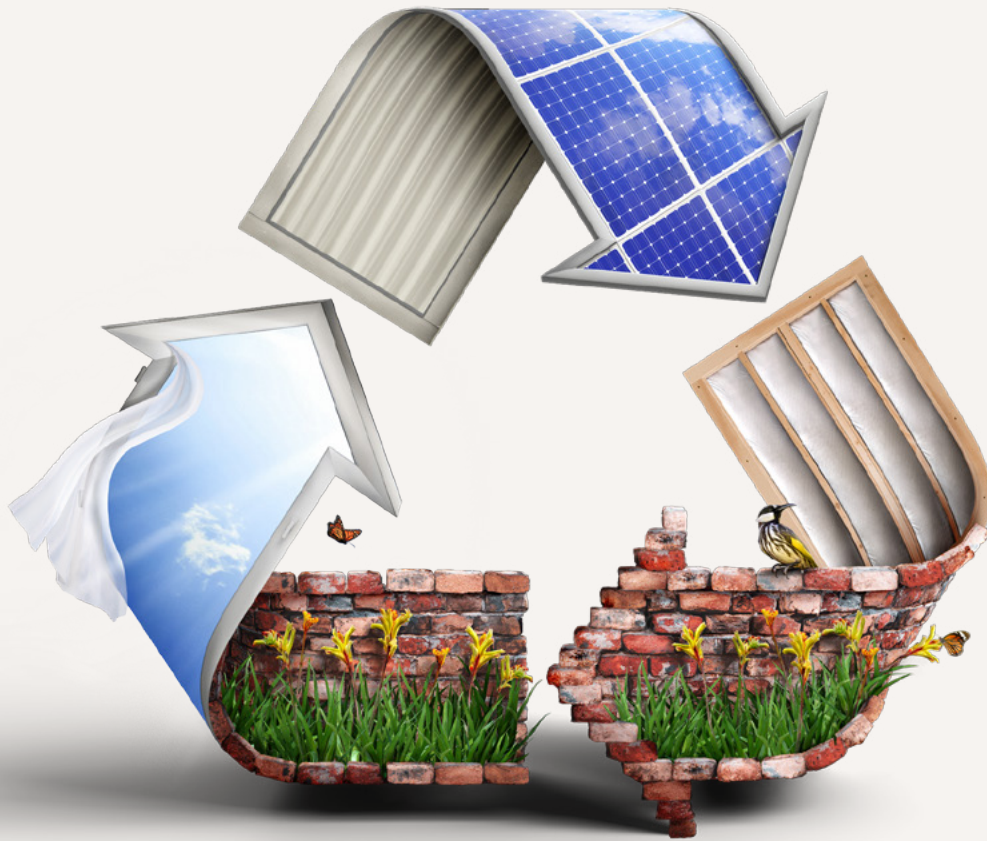

# Building a sustainable future

## Leading the creation of exceptional places for Western Australia.

Through our innovative, climate-responsive planning and our commitment to achieving net zero carbon emissions by 2050, we are committed to building a long-lasting and sustainable future for WA.

We're proud to support the 2024 PIA Awards for Planning Excellence in shaping the future of Western Australia.

[developmentwa.com.au](https://developmentwa.com.au)

*Shaping our State's future*

 **DevelopmentWA**

# End of Year Celebration 2024

Thursday, 5 December 2024 | 5:30 - 9pm | The Rechabite  
(International Volunteer Day)

Planning Institute of Australia, Women in Planning Network WA, and PIA WA Young Planners are delighted to invite you and your colleagues to reflect on the year and celebrate **International Volunteer Day**

Join us for an evening of celebration, drinks, canapes and catching up with friends.

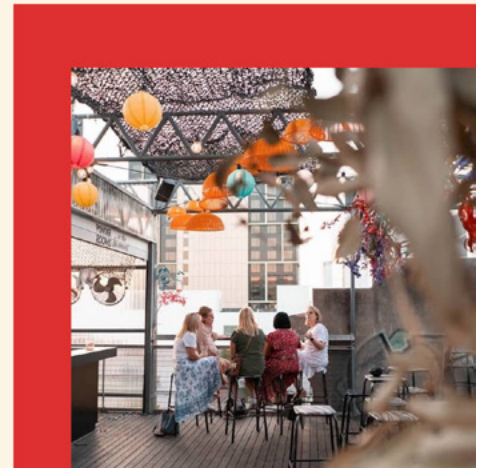

## We're Making Sustainability Happen

Scan the  
QR code  
to find  
out how



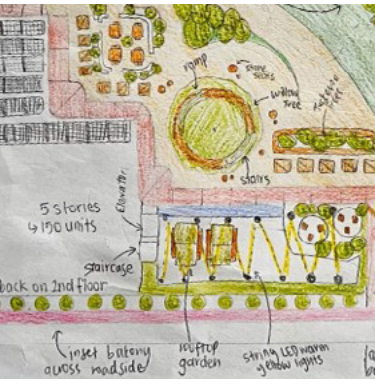



Planning Institute of Australia (PIA) is the national body representing planning and the planning profession. Through education, communication and professional development, PIA is the pivotal organisation serving and guiding thousands of planning professionals in their role of creating better communities.

PIA currently represents approximately 5300 members nationally and internationally, and connects with more than 10,500 planners annually. We are governed by a National Board of Directors and managed by a professional administration. We are a member-based organisation with its management complemented by volunteers, who support and contribute to our activities on various levels.

Our mission is to champion the role of planning in shaping Australia's future. PIA will do this through strong leadership, advocacy and contemporary planning education.

Our vision is for PIA to be Australia's trusted voice on Planning.